



Operating Instructions for the
POWER POINTER
tungsten electrode grinding machine



Litty Handelsgesellschaft mbH

Kaltenbacher Weg 12
D - 83355 Erlstätt

Tel.: +49(0)861 90 98 160

Fax: +49(0)861 90 98 161

E-mail: Litty@tungsten.de

www.tungsten.de

Contents

	Page
Power Pointer (positioning)	3
Grinding tungsten electrodes with the Power Pointer	4
Standard functions	4
Retrofit kit	4
Changing the diamond disk	5
General instructions	6

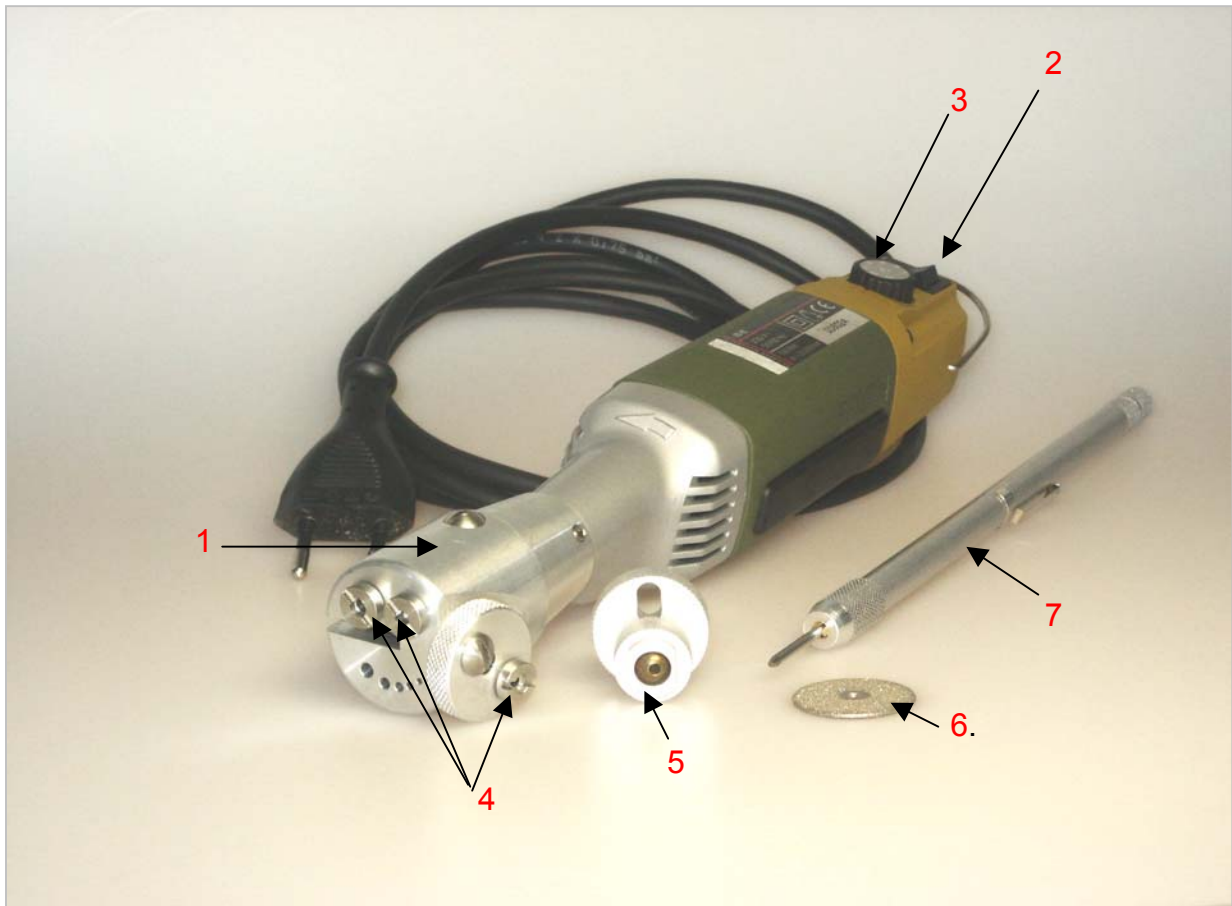

Item No.	Designation
1	Grinding head with integrated diamond disk
2	On / Off switch
3	Speed adjustment
4	Inserts with hole for the required electrode diameter
5	Retrofit kit for grinding different angles (Ø 1,6 / 2,4 / 3,2)
6	Replacement diamond disks (coated both sides)
7	Grinding jig / Tig point

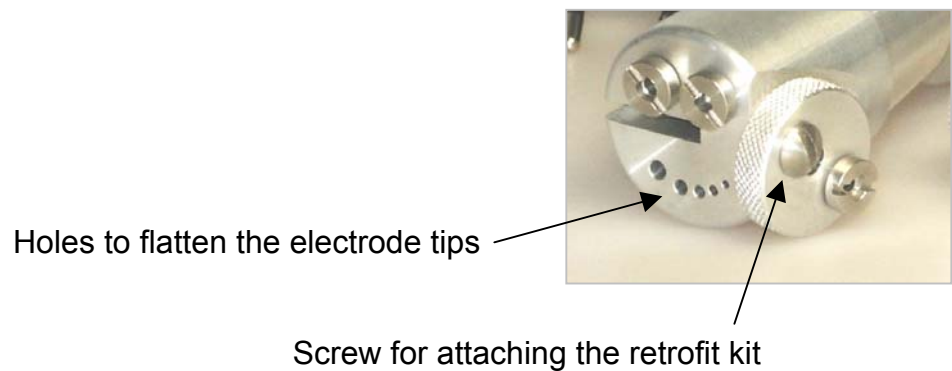

Grinding tungsten electrodes with the Power Pointer

1. Clamp the electrode in the grinding jig (TIG tip) with a projection of about 30 mm.

2. Fit insert of the corresponding electrode diameter (see Page 3, Item No.4).

3. Switch on machine and set speed (good grinding results are obtained at 16 000 – 17 000 rev/min).



4. Standard functions

a) Put electrode into the insert and start grinding the tip while smoothly turning it.



b) To "flatten" the electrode on the front face introduce it into the corresponding hole and grind the tip.



c) To "cut the electrode to length" put it into the slot and with the help of the diamond disk cut a notch on the circumference. Then break it.



5. Retrofit kit:

- Secure retrofit kit with the screw.
- Set desired angle.
- Grind tungsten electrode.

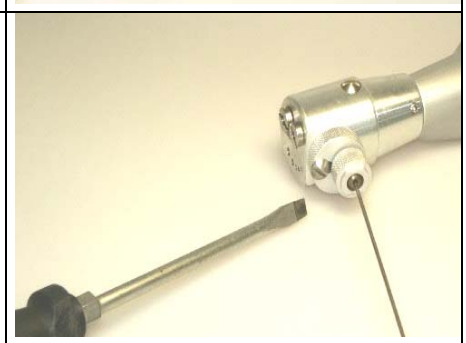

6. Change diamond disk:

a) Slacken screw.

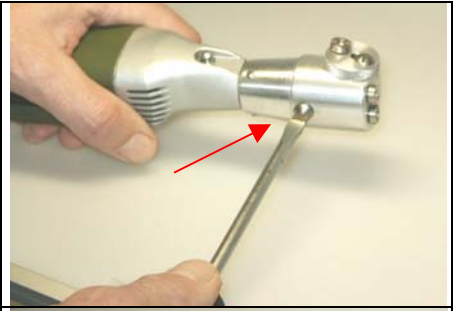

b) Pull off grinding head.



c) Remove screw and take off diamond disk (see next picture).



7. Tighten the grinding disk holder:

a) Slacken the three setscrews with an Allen key and remove the upper part.



b) Lock the motor with the press button and tighten the chuck with the help of a 10 size spanner. Then reassemble the machine in the reverse order.



General instructions

1. When grinding tungsten electrodes always wear suitable safety goggles.
2. Only use the machine if it is in a safe and undamaged condition.
3. When changing the diamond disk or doing any other work on the tool always pull out the plug.
4. When using the grinding machine always take basic safety precautions including those to prevent fire, shock and personal injury.
5. The safety instructions and data sheets of the electrode manufacturer or suppliers regarding the danger of dust, radiation and poison, including the instructions for disposal must be followed.
6. The Power Pointer does not require any special maintenance. It is however recommended that the grinding head should be removed from time to time and cleaned.